



accommodations

Room Type	Size (sq m)	No. Of Units
Deluxe Garden View	35	57
Deluxe Sea Facing	35	143
Deluxe Sea View	35	31
Executive Suite	35	7
Executive Deluxe	40	3
Honeymoon Suite	35	3
Bay Suite	100	1
Damai Suite	200	1



facilities & services

- 24-hour Security
- 24-hour room service
- Baby Sitting (upon request)
- Business Centre with Secretarial Services
- Complimentary Bottled Water
- CCTV Surveillance on All Floors
- Check-in 3.00 pm. Check-out 12.00 noon
- Coffee/Tea Making Facilities
- Complimentary Scheduled Shuttle Services to Major Business and Shopping Destinations
- Convenience Store
- Concierge
- Currency Exchange
- Daily Newspaper
- DVD player (upon request)
- Fitness Centre
- Golf Course
- Gymnasium
- Hairdryer
- IDD Telephone
- Individually Controlled Air-Conditioning
- In-room Dining
- In-room Electronic Safe
- Iron & Ironing Board
- Jacuzzi
- Kids Room
- Limousine Service
- Minibar
- Non-smoking Rooms
- Prayer Room / Surau
- Same day Laundry and Dry Cleaning Service
- Samsara Spa
- Sauna
- Satellite TV (News/Movies/Sports) / In house Movies/Local Stations
- Souvenir Kiosk
- Swimming & Wading Pool with Sundeck
- Travel, Tour Desk and Car Hire Information
- Vegetarian Cuisine (upon request)
- Wireless High-speed Broadband Internet Access
- Work Desk

location map



meeting & events @ Swiss-Garden Golf Resort & Spa Damai Laut



the perfect escapade

from the harried pace of modernisation.



Persiaran Swiss-Garden, Jalan Damai Laut,
Off Jalan Teluk Senangin, 32200 Lumut, Perak Darul Ridzuan, Malaysia
T +605 684 3333 | F +605 618 3388 | E resvns_sgrsd@swissgarden.com | W www.swissgarden.com

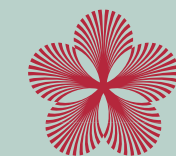

SWISS-GARDEN GOLF RESORT & SPA
DAMAI LAUT • OFF PANGKOR ISLAND • MALAYSIA

idyllic location



Swiss-Garden Golf Resort & Spa Damai Laut, Lumut is an international beach resort with 300 guest rooms. Easily accessible from Kuala Lumpur by air, road and rail, it is an ideal and idyllic getaway retreat for golfing, exhilarating watersports, business meetings and conferences.

accessibility

The resort is a scenic 4 hours drive on the North-South Expressway from Kuala Lumpur and 2 hours from Penang via Changkat Jering exit. Regular scheduled flights from Kuala Lumpur International Airport (KLIA) to Penang Airport are also available while the main Railway Station in Ipoh is about 80km from the resort.

nearby attractions

- Bota Kanan Conservation Centre
- Charcoal Factory
- Coral Bay Fish Feeding
- Gua Tempurung
- Kellie's Castle
- Kuala Sepetang Fishing Village
- Matang Mangrove Forest Reserve
- Matang Museum
- Pasir Salak Historical Complex
- Pangkor Island Drop
- Perak Museum
- Segari Turtle Sanctuary
- Teluk Penyu Coral Watching
- The River Terrapin Breeding Centre
- Trong Hot Spring

food & beverages outlets

THE GARDEN TERRACE

Dine at the Garden Terrace with the serene seascape of the Straits of Malacca and tempt your taste buds with dishes made up of Asian and Western recipes.

THE GAYAM SEAFOOD BARBECUE & BAR

Dine on seafood freshly grilled to perfection with the sun setting as your backdrop.

BLOSSOM & THAI TASTE RESTAURANT

Blossom & Thai Taste Restaurant is serving our patrons with an extensive menu of authentic Thai cuisines as well as delectable chinese cuisines that will surely satisfy your palate prepared by our famous chefs.

THE BLUE CHIP LOUNGE

Sip on specially concocted cocktails whilst enjoying the panoramic views of Straits of Malacca and the Pangkor Island.

THE NINETEENTH FUN PUB

The Nineteenth Karaoke provides an upbeat karaoke environment with an advanced and computerised set-up for a quicker selection of more than 5,000 songs.

THE SWISS DELI

Exquisite and hip deco combined with impeccable service, this deli will ensure you a tasty treat for your taste buds. Our choice of menu for this deli was inspired by our local and international exquisite dishes.



meet with pleasure

- 2,000 square meters of convention and meeting facilities consist of a ballroom, 5 function rooms and 2 conference rooms
- A host of services available for convention, banquet and themed parties
- State-of-the-art audio visual equipment

FACILITIES

- WIFI internet access
- Audio visual equipment and technician on call
- Video conferencing facilities
- Standard Backdrop with logo
- Writing materials

SOCIAL EVENTS

- Weddings
- Corporate dinners
- Cocktail receptions
- Birthday parties
- Convocations

CORPORATE FUNCTIONS

- Product launches
- Conferences, Meetings and Incentives
- Seminar
- Trade show
- Exhibition

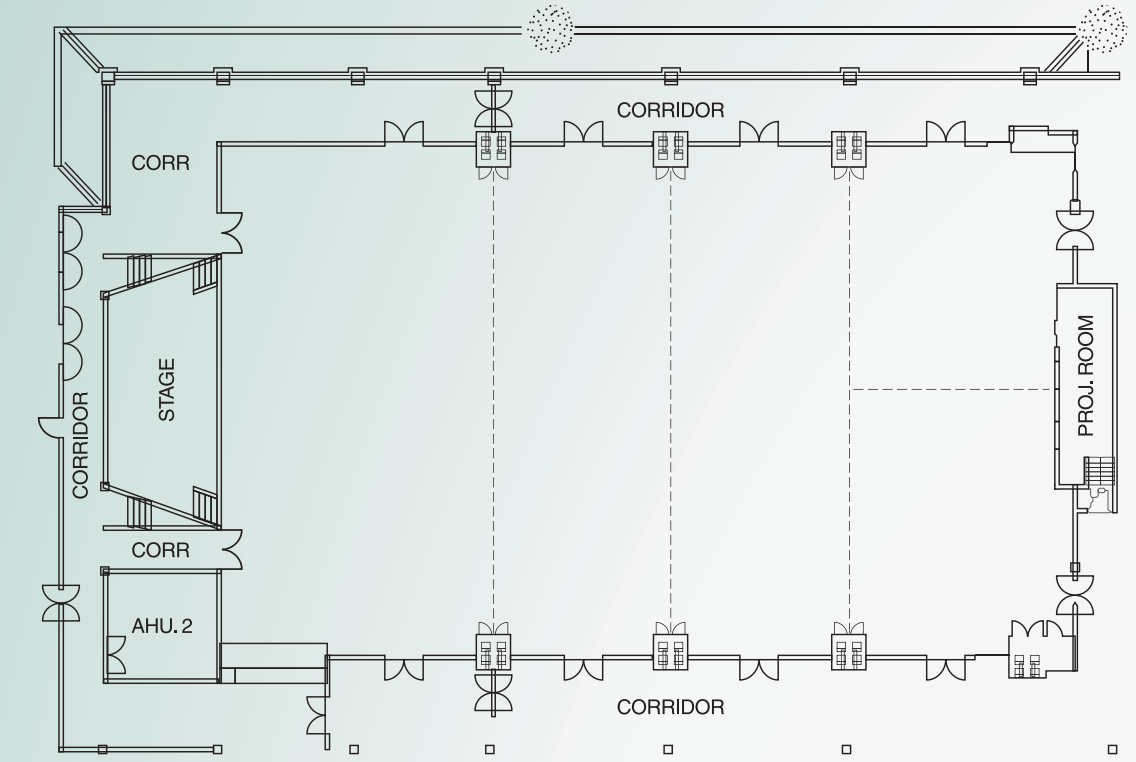

Level	LOCATION	DIMENSION			SEATING CAPACITIES - NUMBER OF PERSONS							
		Length (mtr)	Width (mtr)	Size (sqm)	Cocktail Height	Dinner Sit Down	Dinner Buffet	Theatre Style	Class-room	U-Shape	Hollow-Square	Board-Room
One	Damai Ballroom	38	22.5	885	1000	600	450	1000	462	-	-	-
	Damai 1	22.5	12	270	280	180	120	260	147	48	72	54
	Damai 2	22.5	8	180	190	120	100	180	108	63	66	54
	Damai 3	22.5	8	180	190	120	100	180	108	63	66	54
	Damai 4	11.25	10	112.5	110	70	30	112	45	27	36	24
	Damai 5	11.25	10	112.5	110	70	30	112	45	27	36	24
	Conference Room 1	7.3	9.75	71.18	30	20	-	30	20	20	20	20
	Conference Room 2&3	8.5	5.5	46.75	30	40	40	50	30	20	30	20



team building

THE TEAM BUILDING

- Raft Building & Water Rafting
- Sorting the Tiger
- Tunneling Rat
- Rescue 911
- Treasure Hunt
- Slippery Human Structure
- Build the Scrapers
- Bridge Building
- Railway Bridge

CONFIDENCE BUILDING

- Rope Course
- Jungle Trekking
- Flying Fox
- Canoeing

ROPE COURSE

- Beam Walk
- Tyre Swing
- Postman Walk
- Spider Net
- Burmese Bridge
- Flying Fox

MINI ECO CHALLENGE

- IQ Test (Hand Lock / Numbering / Giant Nail)
- Zigzag Run / Lower Crossing / Swing Bridge
- Kayaking
- Cycling
- Find the objects