



accommodations

Room Type	Size (sq m)	No. Of Units	Club Floor Room Type	Size (sq m)	No. Of Units
Deluxe Garden View	35	63	Deluxe Club Room	35	17
Deluxe Sea Facing	35	167	Club Sea View	35	10
Deluxe Sea View	35	16	Club Suite	70	5
Executive Suite	35	7	Damai Suite	200	1
Executive Deluxe	40	3			
Honeymoon Suite	35	1			



facilities & services

- 24-hour Security
- 24-hour room service
- Baby Sitting (upon request)
- Business Centre with Secretarial Services
- Complimentary Bottled Water
- CCTV Surveillance on All Floors
- Check-in 3.00 pm. Check-out 12.00 noon
- Coffee/Tea Making Facilities
- Complimentary Scheduled Shuttle Services to Major Business and Shopping Destinations
- Convenience Store
- Concierge
- Currency Exchange
- Daily Newspaper
- DVD player (upon request)
- Fitness Centre
- Golf Course
- Gymnasium
- Hairdryer
- IDD Telephone
- Individually Controlled Air-Conditioning
- In-room Dining
- In-room Electronic Safe
- Iron & Ironing Board
- Jacuzzi
- Kids Room
- Limousine Service
- Minibar
- Non-smoking Rooms
- Prayer Room / Surau
- Same day Laundry and Dry Cleaning Service
- Samsara Spa
- Sauna
- Satellite TV (News/Movies/Sports) / In-house Movies/Local Stations
- Souvenir Kiosk
- Swimming & Wading Pool with Sundeck
- Travel, Tour Desk and Car Hire Information
- Vegetarian Cuisine (upon request)
- Wireless High-speed Broadband Internet Access
- Work Desk

location map



meeting & events @ Swiss-Garden Beach Resort Damai Laut



the perfect escapade

for a perfect retreat.



Persiaran Swiss-Garden, Jalan Damai Laut,
Off Jalan Teluk Senangin, 32200 Lumut, Perak Darul Ridzuan, Malaysia
T +605 684 3333 | F +605 618 3388 | E resvns_sgrsd1@swissgarden.com | W www.swissgarden.com

KL SALES OFFICE
2nd Floor, Swiss-Garden Hotel, No. 117, Jalan Pudu, 55100 Kuala Lumpur, Malaysia
T +603 2145 3833 | F +603 2143 1833 | E salescod1_sgrsd1@swissgarden.com



idyllic location



Swiss-Garden Beach Resort Damai Laut, Lumut is an international beach resort with 300 guest rooms. Easily accessible from Kuala Lumpur by air, road and rail, it is an ideal and idyllic getaway retreat for golfing, exhilarating watersports, business meetings and conferences.

accessibility

The resort is a scenic 3 hours drive on the North-South Expressway from Kuala Lumpur and 2 hours from Penang via Changkat Jering exit. Regular scheduled flights from Kuala Lumpur International Airport (KLIA) to Penang Airport are also available while the main Railway Station in Ipoh is about 80km from the resort.

nearby attractions

- Bota Kanan Conservation Centre
- Charcoal Factory
- Coral Bay Fish Feeding
- Gua Tempurung
- Kellie's Castle
- Kuala Sepetang Fishing Village
- Matang Mangrove Forest Reserve
- Matang Museum
- Pasir Salak Historical Complex
- Pangkor Island Drop
- Perak Museum
- Segari Turtle Sanctuary
- Teluk Penyu Coral Watching
- The River Terrapin Breeding Centre
- Trong Hot Spring

food & beverages outlets

THE GARDEN TERRACE

Dine at the Garden Terrace with the serene seascape of the Straits of Malacca and tempt your taste buds with dishes made up of Asian and Western recipes.

THE GAYAM SEAFOOD BARBECUE & BAR

Dine on seafood freshly grilled to perfection with the sun setting as your backdrop.

THAI TASTE CUISINE RESTAURANT

Extensive Thai menu served by chefs from Bangkok with great ambience and enjoyable dining experience!

THE BLUE CHIP LOUNGE

Sip on specially concocted cocktails whilst enjoying the panoramic views of Straits of Malacca and the Pangkor Island.

DAMAI CLUB LOUNGE

Guest at the Damai Club Floor will enjoy full privilege to indulge and unwind in the exclusive Damai Club Lounge amidst a compelling panoramic sea view. The Damai Club Lounge is the perfect setting for social gatherings, corporate cocktails and business luncheons.



meet with pleasure

- 2,000 square meters of convention and meeting facilities consisting of a ballroom, 5 function rooms and 2 conference rooms
- A host of services available for convention, banquet and themed parties
- State-of-the-art audio visual equipment

FACILITIES

- WIFI internet access
- Audio visual equipment and technician on call
- Video conferencing facilities
- Standard Backdrop with logo
- Writing materials

SOCIAL EVENTS

- Weddings
- Corporate dinners
- Cocktail receptions
- Birthday parties
- Convocations

CORPORATE FUNCTIONS

- Product launches
- Conferences, Meetings and Incentives
- Seminar
- Trade show
- Exhibition

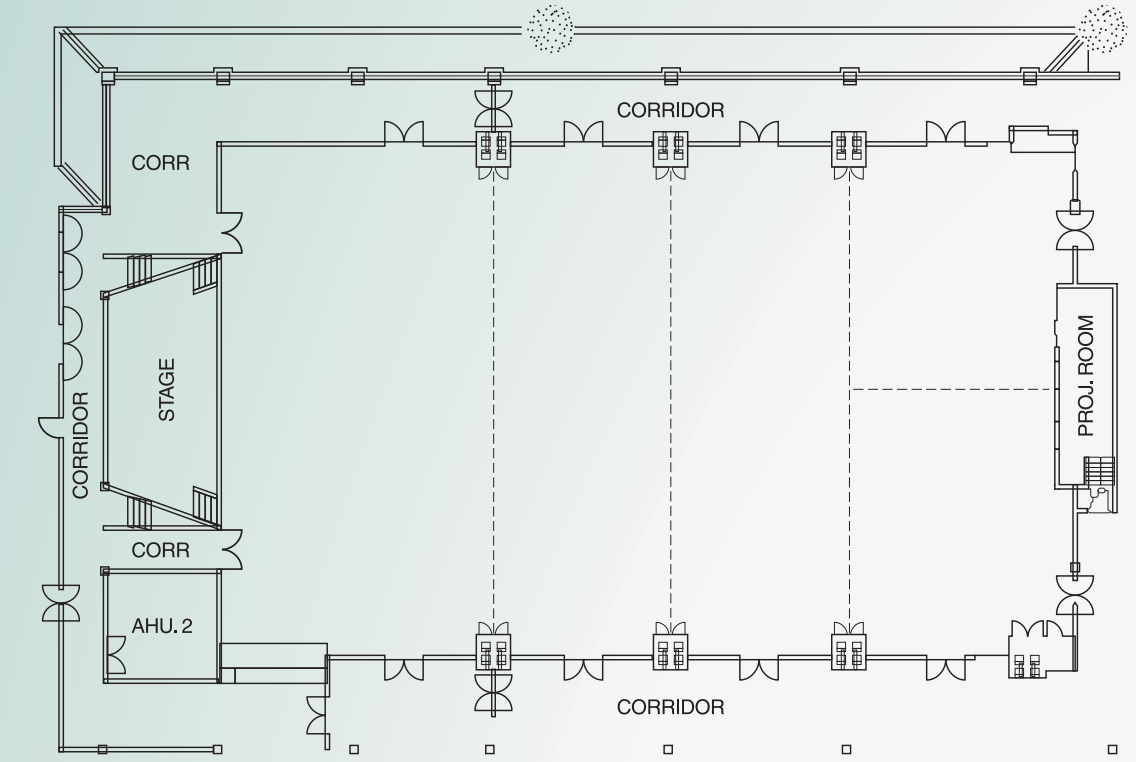

Level	LOCATION	DIMENSION				SEATING CAPACITIES - NUMBER OF PERSONS						
		Length (mtr)	Width (mtr)	Size (sqm)	Ceiling Height(mtr)	Cocktail	Dinner Sit Down	Dinner Buffet	Theatre Style	Class-room	U-Shape	Board Room/Hollow Square
One	Damai Ballroom	38	22.5	885	5.7	800	600	500	1000	450	-	-
	Damai 1	22.5	12	270	5.7	250	150	120	260	130	48	55
	Damai 2	22.5	8	180	5.7	150	120	100	150	100	50	53
	Damai 3	22.5	8	180	5.7	150	120	100	150	100	50	53
	Damai 4	11.25	10	112.5	5.7	100	50	30	100	30	20	23
	Damai 5	11.25	10	112.5	5.7	100	50	30	100	30	20	23
	Conference Room 1	7.3	9.75	71.18	2.8	-	-	-	20	20	15	18
	Conference Room 2&3	8.5	5.5	46.75	2.4	-	-	-	40	30	20	23



team building

THE TEAM BUILDING

- Raft Building & Water Rafting
- Sorting the Tiger
- Tunneling Rat
- Rescue 911
- Treasure Hunt
- Slippery Human Structure
- Build the Scrapers
- Bridge Building
- Railway Bridge

CONFIDENCE BUILDING

- Rope Course
- Jungle Trekking
- Flying Fox
- Canoeing

ROPE COURSE

- Beam Walk
- Tyre Swing
- Postman Walk
- Spider Net
- Burmese Bridge
- Flying Fox

MINI ECO CHALLENGE

- IQ Test (Hand Lock / Numbering / Giant Nail)
- Zigzag Run / Lower Crossing / Swing Bridge
- Kayaking
- Cycling
- Find the objects